

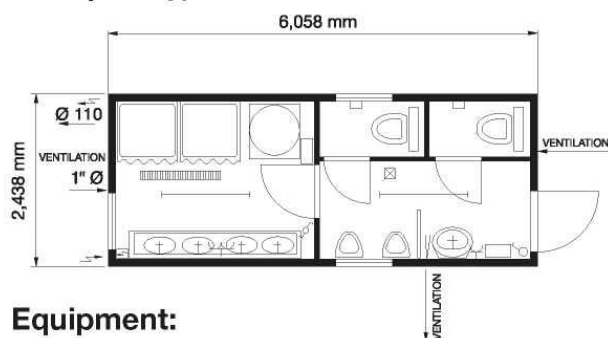

Types: SA 10' and SA 20'



Floor plan Type SA 20':



Type SA 10':

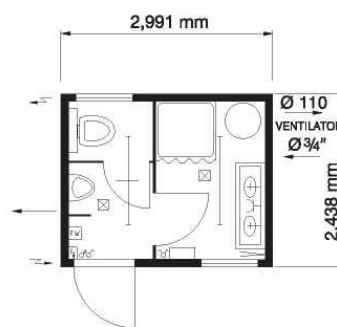

Equipment:

**Type SA 20':**

- 2 WC cubicles, complete
- 2 shower cubicles incl. fittings
- 1 fibre glass 240 cm wash trough with 4 hot + cold mixer taps, soap trays and towel holders
- 1 hand wash-basin
- 5 metal mirrors
- 2 urinals with push-button flusher, 1 partition
- 1 pressure reducing valve
- 1 electric-ventilator
- 1 hot water tank with electric immersion heater
- 2 electric fan heaters
- 1 floor drainage channel (shower) 1 gully (WC)

**Type SA 10':**

- 1 WC cubicle, complete
- 1 shower cubicle incl. fittings
- 1 fibre glass 120 cm wash trough with 2 hot + cold mixer taps, soap trays and towel holders
- 2 metal mirrors
- 1 urinal with push-button flusher 1 pressure reducing valve 1 electric-ventilator 1 hot water tank with electric immersion heater
- 1 electric fan heater
- 1 thermostat freeze temperature control
- 2 gullies (shower, WC)

**Dimensions (mm) and weights (kg):**

Type	external			internal			weight
	length	width	height	length	width	height	
SA10'	2,991	2,438	2,591	2,801	2,248	2,340	2,100
SA20'	6,058	2,438	2,591	5,868	2,248	2,340	2,900

## Technical details:

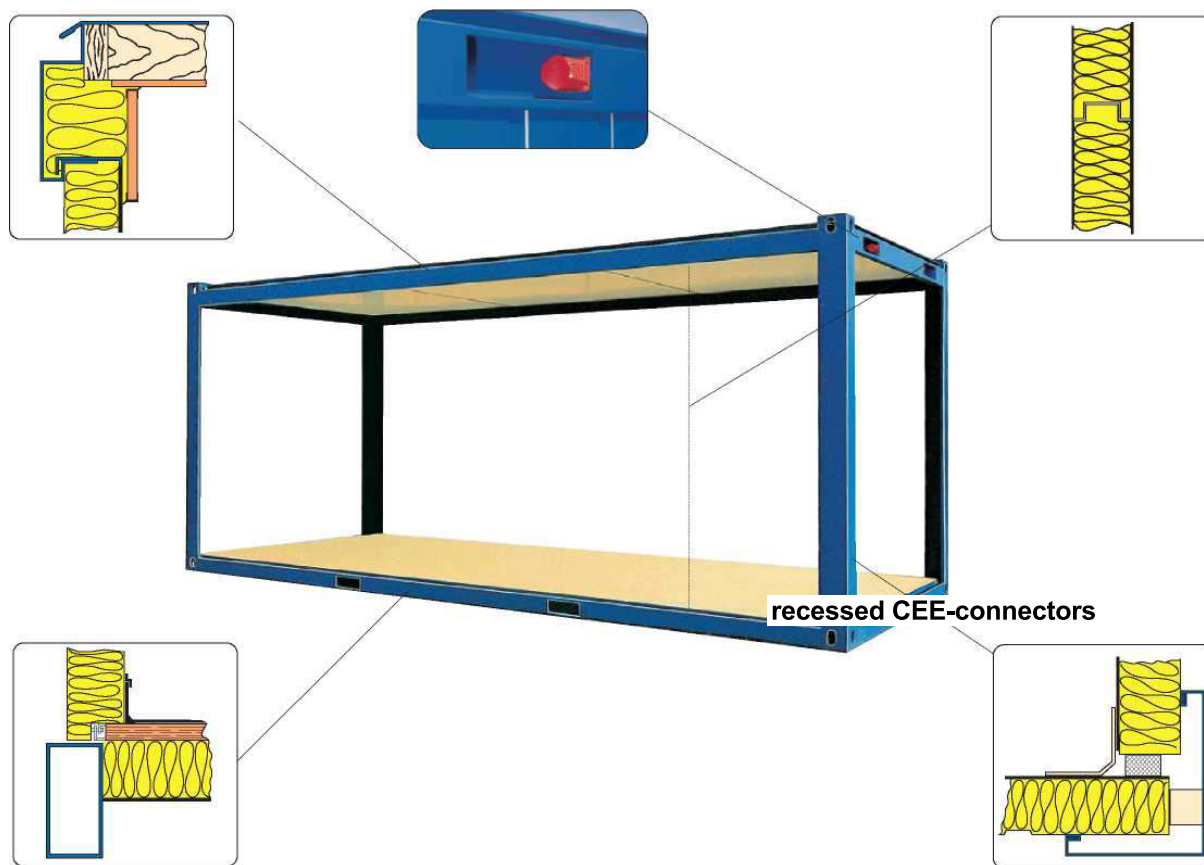

**Frame:**  
solid steel frame construction with welded corner casts and fork-lift pockets as well as recessed CEE connectors

**Wall panels:**  
profiled galvanised steel sheet outside, high quality polyurethane heat and sound insulation, galvanised steel sheet - laminated on both sides (white, highly waterproof)

**Roof:**  
galvanised steel sheet, roof pitch 1.5%, high quality heat insulation, (max. pressure 1.5 kN/m<sup>2</sup>)

**Floor:**  
cement bound chipboard, welded PVC-floor, high quality heat and moisture insulation; (max. pressure 2.5 kN/m<sup>2</sup>)

See technical description for further details.  
Subject to technical alterations.

## Water-installation:

**Supply:**  
pipe dimension (outside thread) - 3/4" (NW 20) or 1" (NW 25) through the side (PVC-piping; freeze-proof, easy to repair without any special tools)

**Outlet:**  
waste water collection via PVC-pipes (NW 50 mm or 100 mm diameter) leading through the wall panel.